

Architectural Design & Construction

2024-25

SA1 ARCH-P-7115

Prof. ir. Geneviève Martin



WOOD vs CONCRETE



Sustainability Context



Course Aspects

- **Theoretical Aspect**
 - **Material Properties:** Studying the behavior of construction materials > wood/concrete,
- **Vocabulary Aspect**
 - Focus on the **specific terminology** used in structural engineering
- **Company Visits**
 - **Site Tours:** Observing ongoing construction projects and understanding the practical application of theoretical knowledge.
 - **Expert Talks** : Sessions with industry professionals discussing
- **Learning by Construction**
 - This **hands-on approach** involves students in actual construction projects, allowing them to apply their knowledge practically
- **Design**
 - A **woodworking space**

Wood

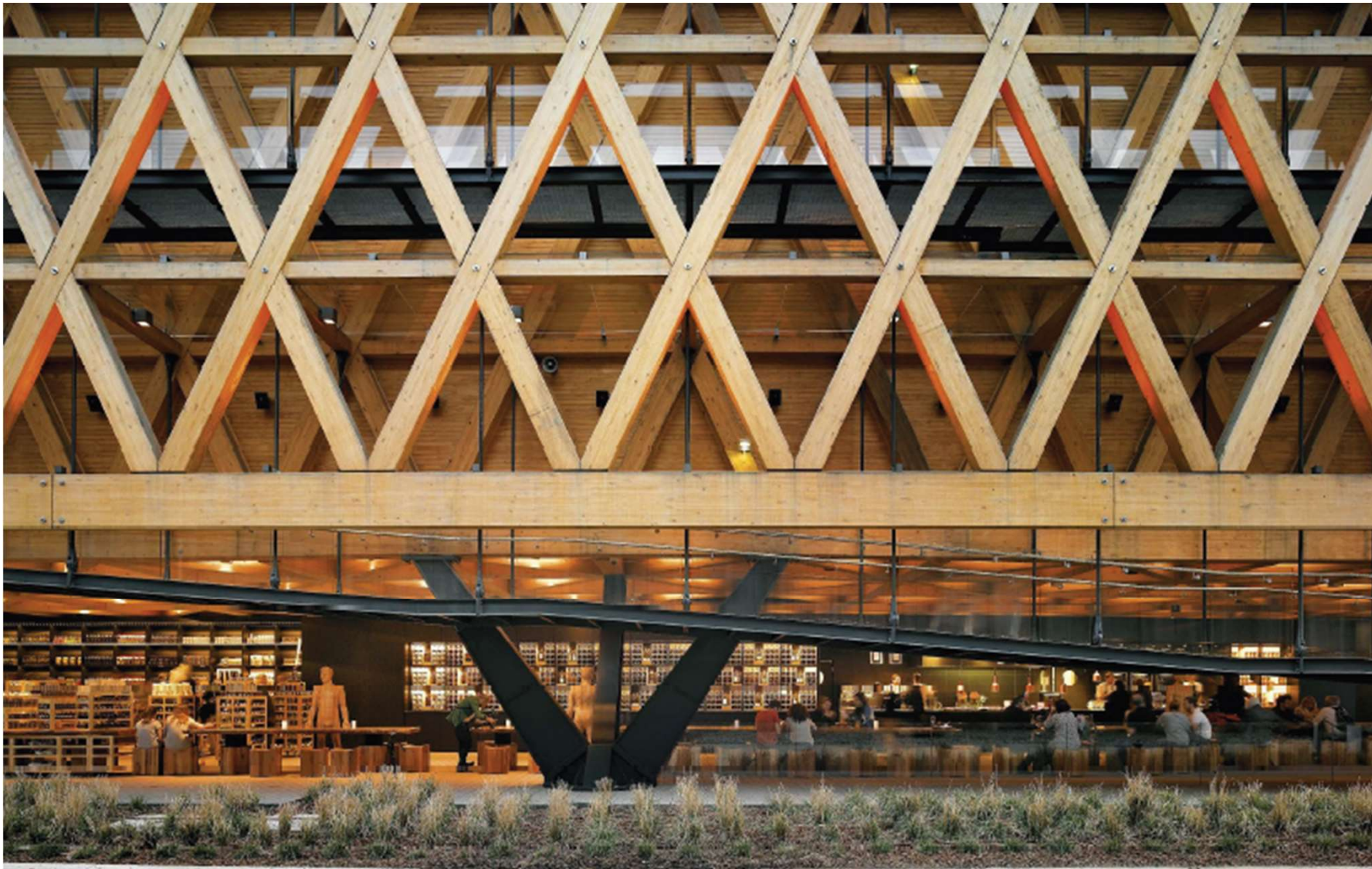



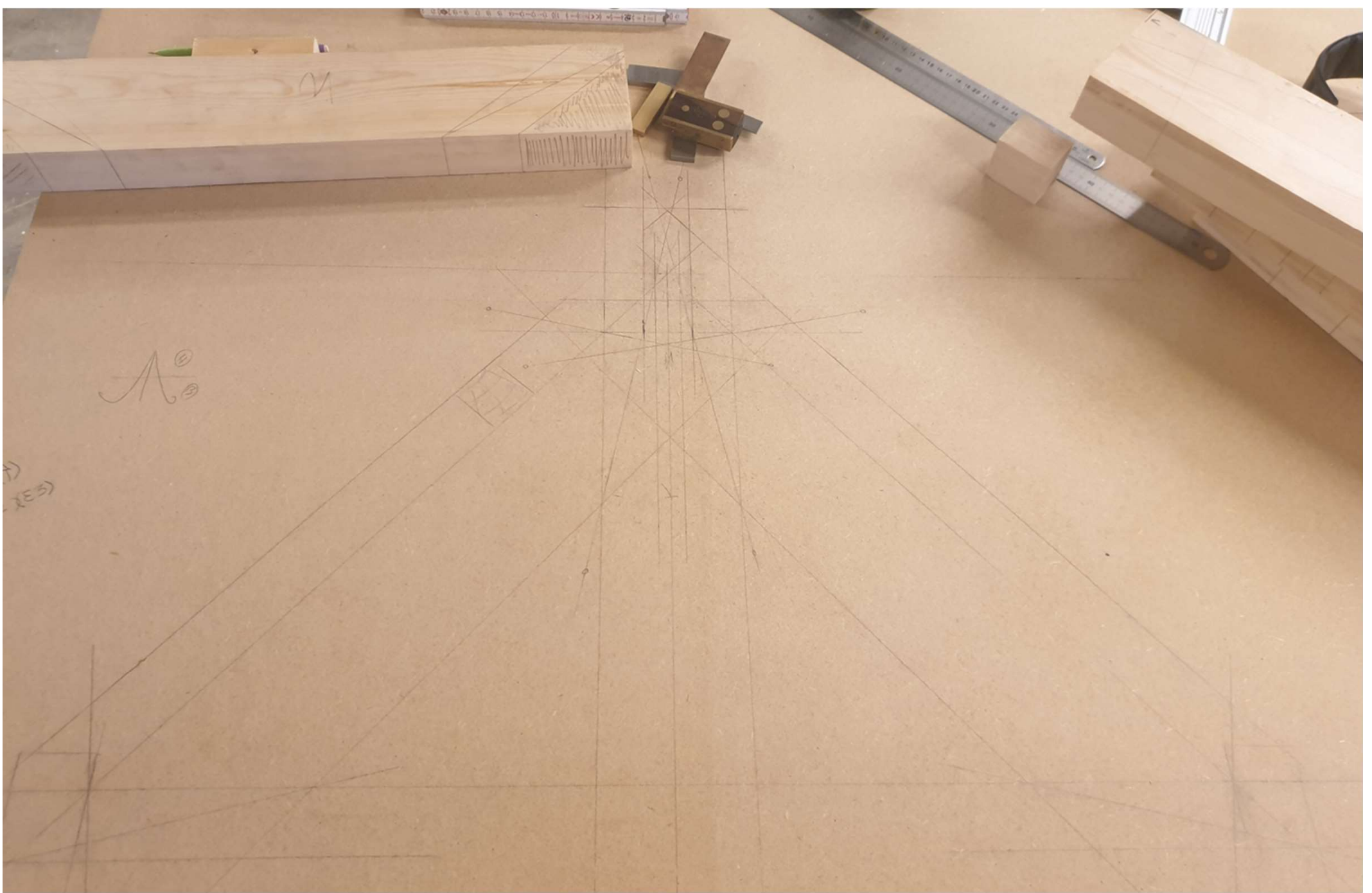

16/11/2023

Architectural Design & Construction_Prof.
ir. G. Martin

Technical Language of the Frame

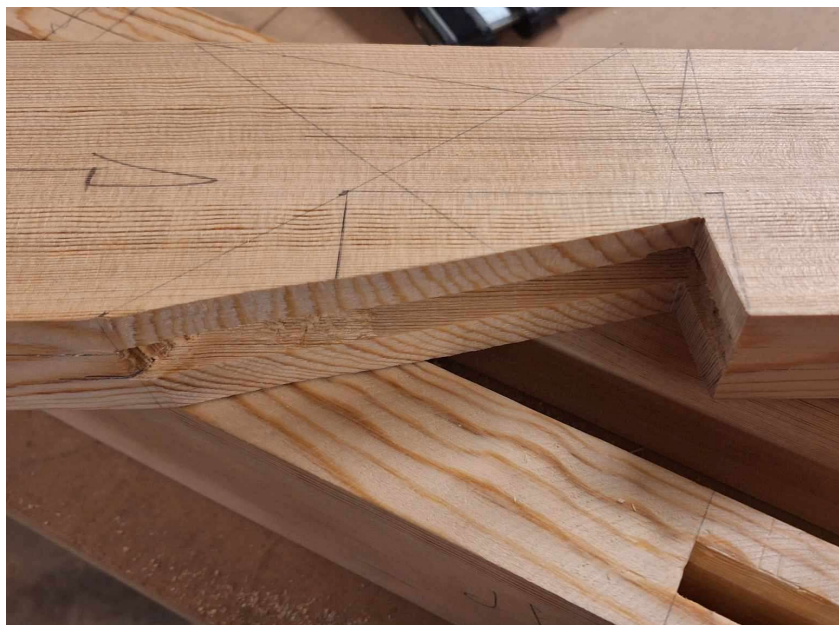

Mortise



Tenon

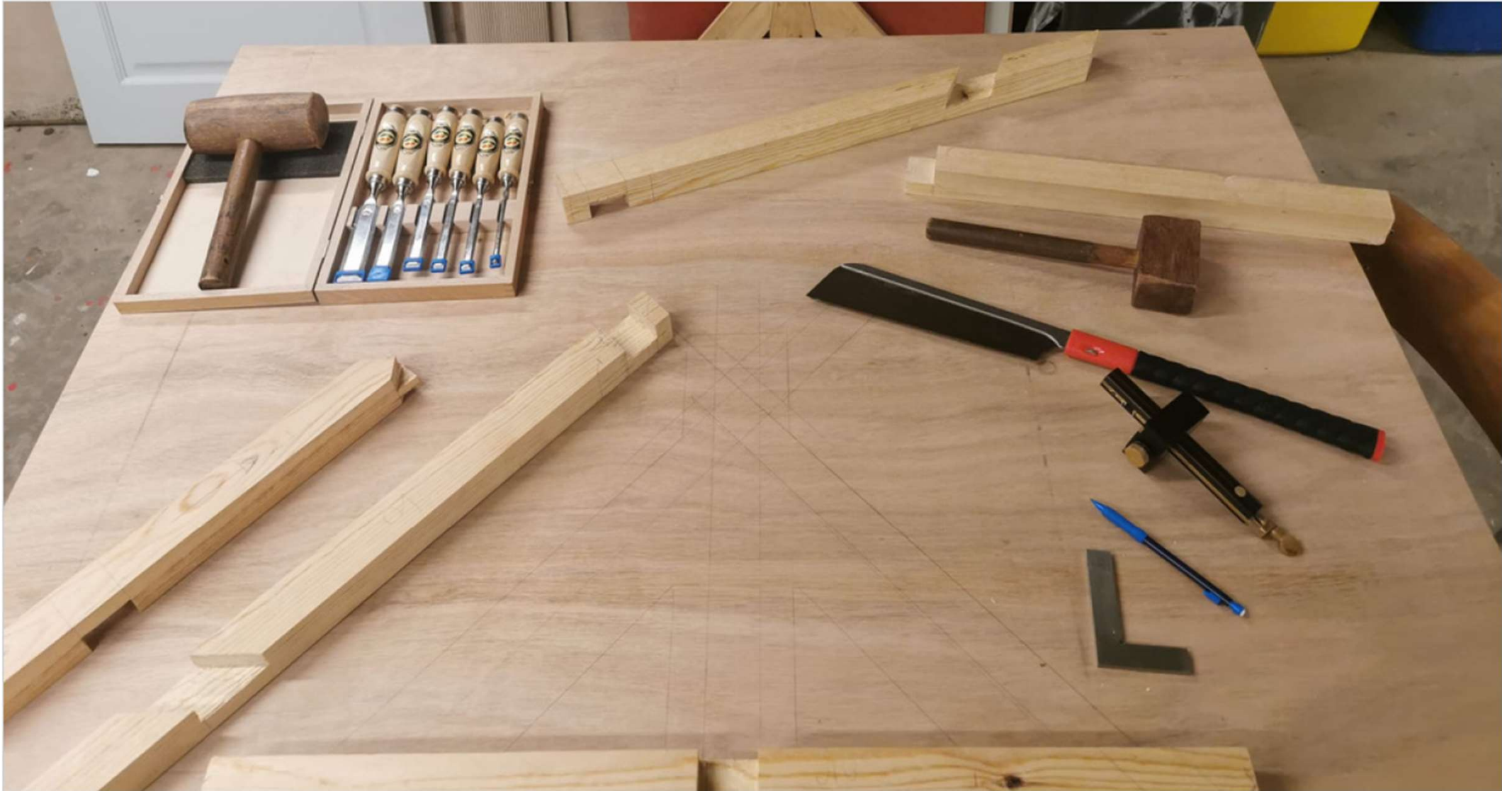

14/09/2022

Architectural Design & Construction
Prof. ir. G. Martin



14/09/2022

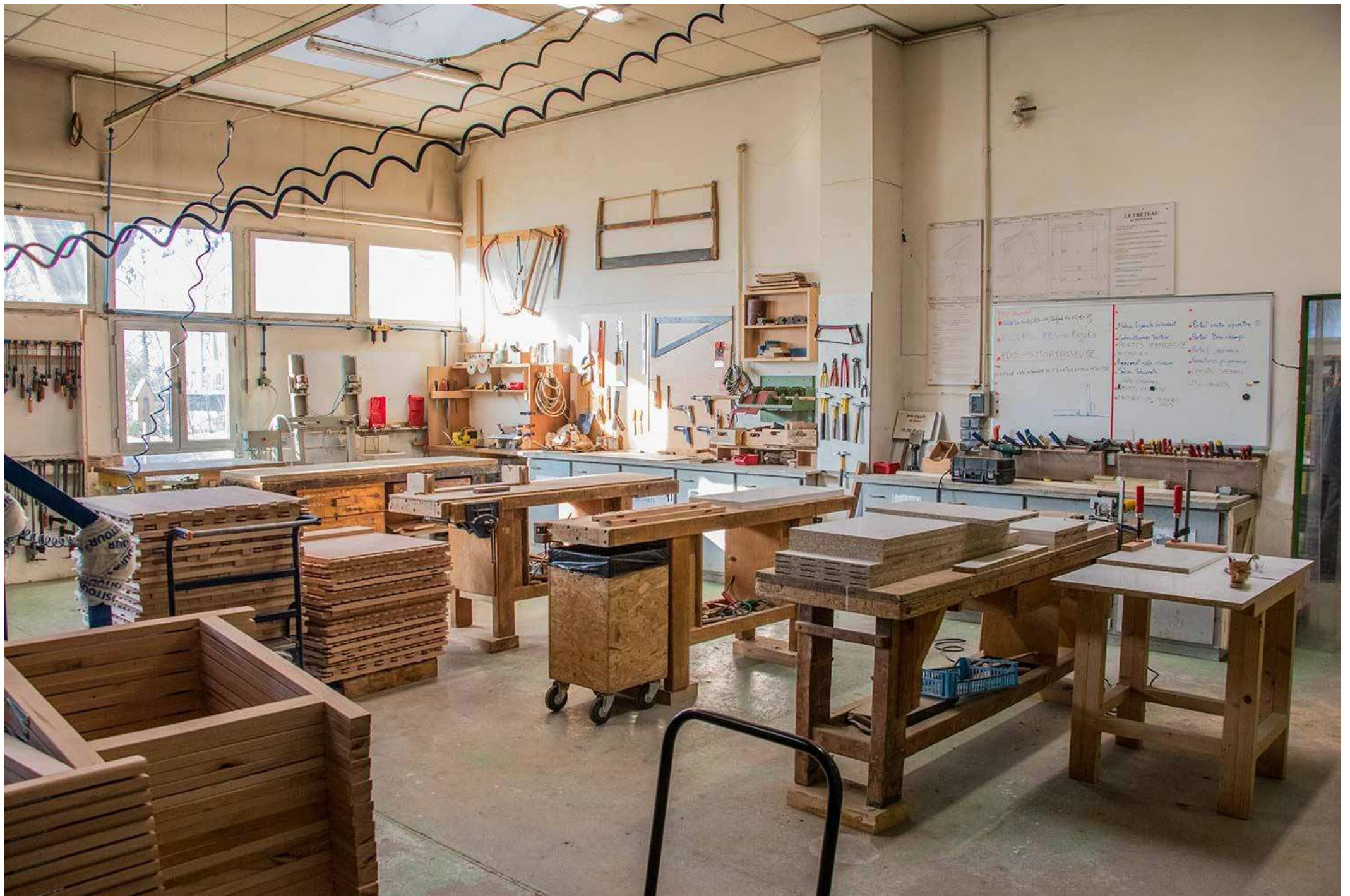

14/09/2022

Architectural Design & Construction
Prof. ir. G. Martin



Concrete

We push to evaluate the technical and constructive principles, to analyse and use technical documents and to **dialogue professionally** with the engineer based on rigorous structural reflexivity.





14/09/2022



14/09/2022

Architectural Design & Construction
Prof. ir. G. Martin

Structural and material studies are applied in the frame of an architectural project bringing out **building materials**.



14/09/2022

Architectural Design & Construction
Prof. ir. G. Martin



14/09/2022

Architectural Design & Construction
Prof. ir. G. Martin



14/09/2022

Architectural Design & Construction
Prof. ir. G. Martin



METHODOLOGY

- Visits, lectures, articles, interactive pedagogy
- Practice of English with « Content and Language Integrated Learning » Method



- Thanks for your listening

Prof. ir. Geneviève Martin
Teacher in Mathematics,
Mechanic, Building's
structure and Equipment
genevieve.martin@ulb.be